



VIP-9890-EM VANDAL RESISTANT IP EMERGENCY TALKBACK CALL STATION



The VIP-9890-EM Vandal Resistant IP Handsfree Emergency Talkback Call Station allows provides communication to a single answer location.

Pressing the "Call" button on the call station initiates a call to any SIP telephone, SIP address, PC softphone, Valcom intercom station or to a Valcom IP gateway. When the called party answers, a handsfree talkback communication is enabled. When the called party terminates the call, the connection is terminated automatically.

FEATURES:

- PoE (802.3af)
- Use with Cisco, Nortel, Avaya, and most modern IP Telephone systems
- Call button calls a SIP address or any Valcom Gateway
- Automatic Talkback VOX operation (no Push To Talk button needed)
- Easy, RJ45 plug in, Cat 5 or 6, LAN /WAN 10/100
- SIP or MulticastSoftphone addressable
- All Call 1000's of units with Valcom Gateway
- LED Status Indicator
- Compatible with secure networks
- Supervision with Alert Functions
- Web-based Firmware Upgradeable
- Web Interface For Control And Setup
- DHCP
- High Survivability –No Server Needed
- Vandal Resistant and Tamper-Proof
- Safety Yellow Powder Coated 16AWG Enclosure, brushed stainless steel grille and hardware

SPEAKER
3.5" dia.

SWITCH
Single Pole Momentary Contact

MOUNTING:
Surface Mount

RELAY OUTPUT
(1) Form C contact
Visual LED Status
Programmable activation period

POWER
Extend: 24 VDC @ 325 ma
POE: 802.3af, class 3

NETWORKING
10/100 Mbps Ethernet port
Manual or Dynamic Host Configuration Protocol (DHCP) IP address setup.
Time and date synchronization using SNTP

SPEAKER OUTPUT
100dB @ 4' on-axis

PROTOCOLS
IETF SIP (RFC3261)
IETF IGMP version 3 (RFC3376)
IETF RTP (RFC1889)
IETF RFC2833
Digest Authentication
* Other protocols available upon request

ENVIRONMENT:
Suitable for Indoor Installations

DIMENSIONS AND WEIGHT:
10.0" H x 12.25" W x 4.0" D
(25.4 cm x 31.12 cm x 10.16 cm)
Shipping Weight: 10.75 lb. (4.1kg)

Limited Warranty

Valcom, Inc. warrants its products to be free from defects in materials and workmanship under conditions of normal use and service for a period of one year from the date of shipment. The obligation under this warranty shall be

limited to the replacement, repair or refund of any such defective device within the warranty period, provided that:

1. inspection by Valcom, Inc. indicates the validity of the claim,
2. the defect is not the result of damage, misuse, or negligence after the original shipment,
3. the product has not been in any way repaired by others and that factory sealed units are unopened. (A service charge plus parts and labor will be applied to units defaced or physically damaged).
4. freight charges for the return of products to Valcom, Inc. are prepaid,
5. all units "out of warranty" are subject to a service charge. The service charge will cover minor repairs (major repairs will be subject to additional charges for parts and labor).

This warranty is in lieu of and excludes all other warranties expressed or implied, and in no event shall Valcom, Inc. be liable for any anticipated profits, consequential damages, loss of time or other losses incurred by the buyer in connection with the purchase, operation or use of the product.

This warranty specifically excludes damage incurred in shipment. In the event a product is received in damaged condition, the carrier should be notified immediately. Claims for such damage should be filed with the carrier involved in accordance with the F.O.B. point.

5614 HOLLINS RD N.E. ROANOKE, VA 24019
Email: support@valcom.com

PHONE: 540-563-2000 FAX: 540-362-9800
Web: www.valcom.com

VIP-9890 BASE

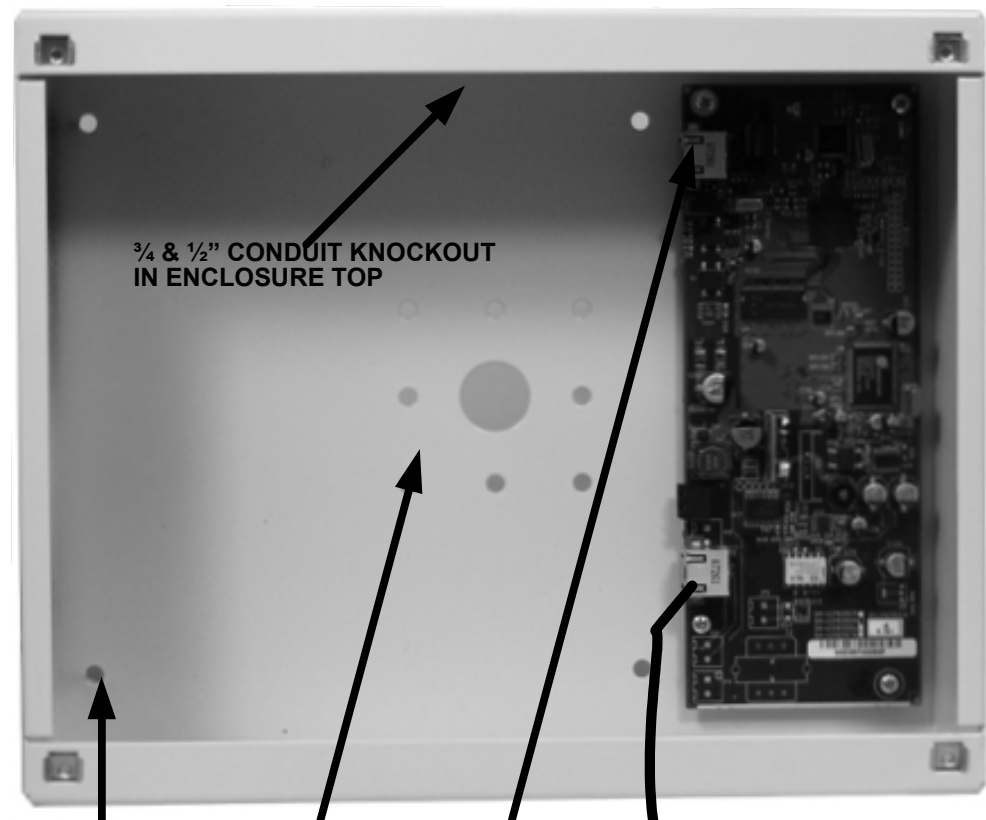

3/4 & 1/2" CONDUIT KNOCKOUT
IN ENCLOSURE TOP

802.3af COMPLIANT PoE Port
(300' CABLE RUN MAX
DISTANCE)

ELECTRICAL BOX MOUNTING
HOLES

(4) HOLES FOR SURFACE
MOUNTING (1/4" HARDWARE)

YELLOW PATCH CABLE
(PROVIDED)

BACK OF GRILLE AUDIO CONNECTION



INSTALLATION INSTRUCTIONS

1. INSTALL BASE USING APPROPRIATE HARDWARE
2. CONNECT RJ-45 CONNECTOR FROM NETWORK. POWER OVER ETHERNET (PoE) IS REQUIRED. IF PoE IS NOT AVAILABLE FROM THE SWITCH, AN INLINE POWER INJECTOR WILL BE REQUIRED.
3. USING THE YELLOW PATCH CABLE PROVIDED AND REFERRING TO FIGURE 1 CONNECT THE FRONT GRILLE CIRCUIT BOARD TO THE BASE CIRCUIT BOARD.
4. FASTEN THE GRILLE TO THE BASE USING THE SCREWS PROVIDED.
5. PROGRAM THE VIP-9890 USING THE VIP-102B IP SOLUTIONS SETUP TOOL (INCLUDED ON THE CD-ROM)